



# FIRESTOP CENTRE

Authorised New Zealand Distributor  
Ph (09) 483 4000 www.firestopcentre.co.nz

## Allproof Low Profile Fire Collar PVC or PEX Pipes in CLT Wall (from 110mm) See Pg 2 for details

### INSTALLATION INSTRUCTIONS:

1. Ensure substrate around pipe is flat and free from obstructions.
2. Open pipe collar and position around pipe.
3. Slide tab through slot in pipe collar and fold back 180° to secure.
4. Secure pipe collar using 12Gx50mm Tek screws. Do not use fixings which rely on plastic or nylon components for grip.
5. Seal the annular gap between wall and the pipe with nominal 13mm Allproof MAS 310 fire sealant.

CLT WALL

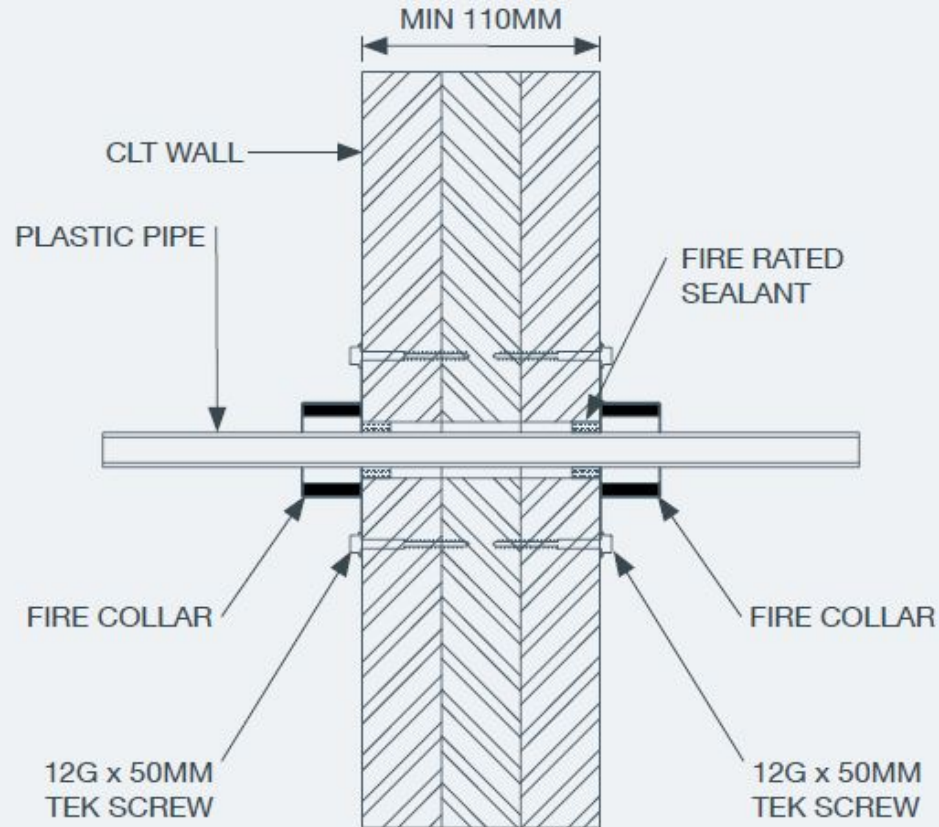

As a part of our policy of on-going product development and testing, we reserve the right to modify, alter or change product specifications without giving notice. All information contained in this document is given in good faith and is provided for guidance only. Any drawings provided are for illustrative purposes only. As Firestop Centre has no control over the methods or competence of installation and of prevailing site conditions, no warranties, expressed or implied, is intended to be given as to the actual performance of the product mentioned or referred to herein and no liability whatsoever will be accepted for any loss, damage or injury arising from the use of the information given.

For all technical details on the products specified please refer to the technical data sheets that can be found on [www.firestopcentre.co.nz](http://www.firestopcentre.co.nz)

Signed and approved:



BRANZ Appraisal 1008  
Technical Manual - Plumbing Pg 13  
AS1530.4-2014 AS4072.1-2005

System ID# FC775

<b>Products</b>	Allproof Low-Profile Fire Collar
<b>Application</b>	Fire stopping of plastic pipes in CLT walls
<b>Construction</b>	Minimum wall thickness of 110mm and comprised of cross laminated timber

### Fire Classification:

See page 2 for details of pipe, hole and wall sizes:

PVC pipes up to 65mm diam FRR -/60/60

PEX pipes up to 25mm diam Up to FRR -/60/45

**ALLPROOF**  
INDUSTRIES

Allproof Industries Ltd  
17 Bay Park Place  
Beach Haven, AK 0626

Sheet size: <b>A4</b>	Drawn date & no: 28/5/25
Scale: <b>NTS</b>	Drawn by: G.P

## CROSS LAMINATED TIMBER (CLT) WALL TEST RESULTS:

NOMINAL PIPE SIZE (MM)	TIMBER DEPTH (MM)	NOMINAL PIPE WALL THICKNESS (MM)	PRODUCT CODE	PENETRATION HOLE SIZE (MM)	WALL FRL	REPORT NUMBER
PVC PLASTIC PIPE						
40	110	2.0	ALLFC40	53	-/60/60	148132
50	110	2.2	ALLFC50	66	-/60/60	148132
65	110	2.7	ALLFC65	78	-/60/60	148132
PEX PIPE						
16	110	2.3	ALLFC25	26	-/60/45	148132
20	110	2.7	ALLFC25	30	-/60/45	148132
25	110	3.2	ALLFC25	35	-/60/30	148132

Fixing: Collars tested using Tek Screw 12G x 50mm.

## CROSS LAMINATED TIMBER INSTALLATION DETAILS:

